

**K. Residential - Minimum**

Not To Scale  
(TSP Figure 4.14)

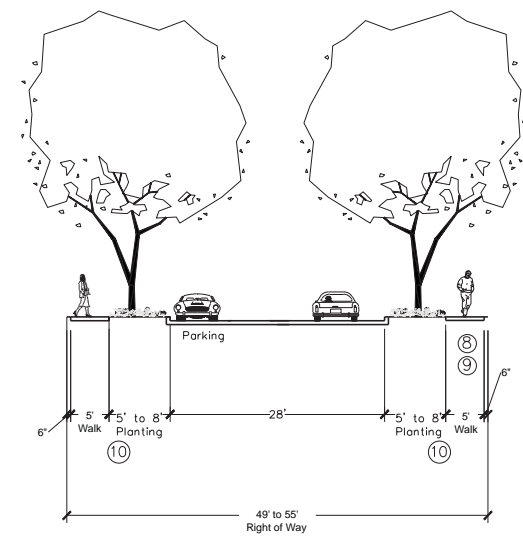

**L. Residential - Parking One Side**

Not To Scale  
(TSP Figure 4.14)

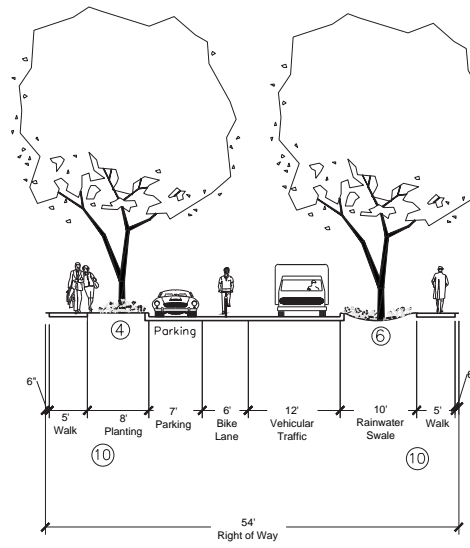

**L. Residential - Parking One Side, One-way Traffic**

Not To Scale  
(TSP Figure 4.14)

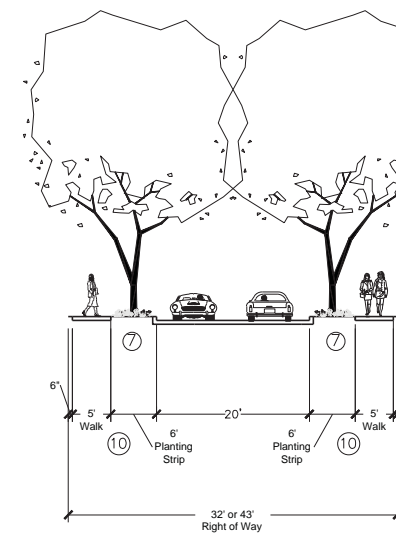

**M. Residential - No Parking**

Not To Scale  
(TSP Figure 4.14)

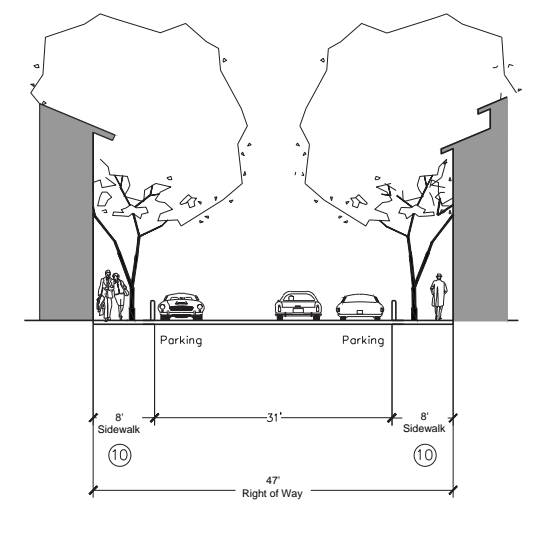

**N1. Private Woonerf**

Not To Scale

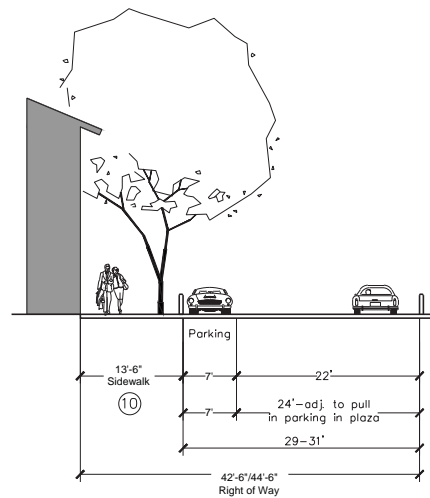

**N2. Private Woonerf - adjacent to Plaza**

Not To Scale

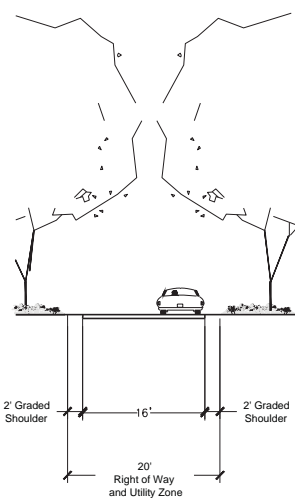

**O. Private Lane**

Not To Scale

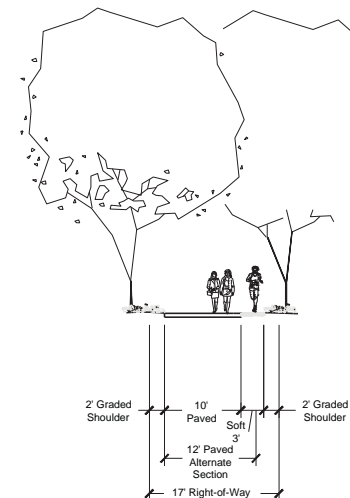

**P. Major Pathway**

Not To Scale

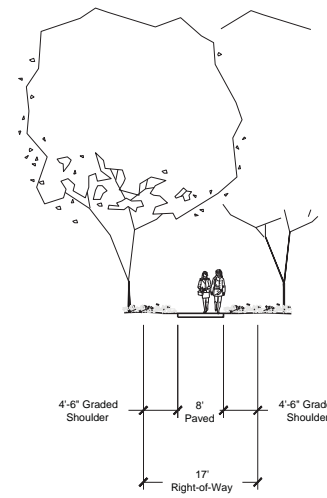

**Q. Minor Pathway**

Not To Scale

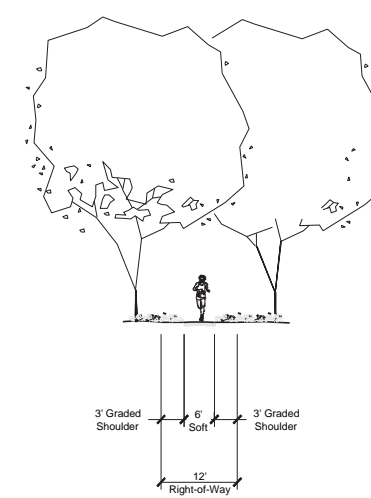

**R. Nature Trail**

Not To Scale

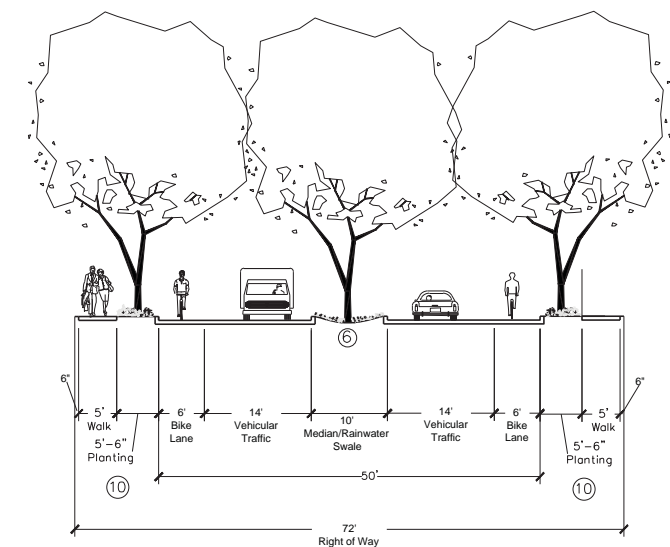

**T. Residential - Median**

Not To Scale

**NOTES:**

- No parking where turn lanes are required at intersections or at Graham's Ferry Road.
- Rainwater swales are not required for streets with grades in excess of 8%.
- Section to be determined by Boeckman extension project or future studies.
- In the village center the sidewalk may be widened to include the planting area when adjacent to retail/commercial uses.
- Blocks over 330' will have a mid-block Pedestrian crossing. This same area will provide 20 feet clear for vehicle passing on Queuing streets.
- See 06A Submission for swale locations.
- No planting strip at Greenway crossings. Provide minimum 5' clear sidewalk from back of curb.
- Walkway and planting strip optional when adjacent to multi-use trail.
- The Right of Way shall be reduced to 12' behind face of curb where adjacent to open spaces.
- Dry Utilities in sidewalk and planter area where necessary. Individual unit service to be in private lane where available.
- 34' width for LEC access road may be revised with the SAP Plans to a 32' access road.
- Continuous turn lane at Graham's Ferry Road.
- 46' width when adjacent to Linear Green.
- Sidewalk becomes 13.5', planting strip is removed and Right of Way becomes 61' when adjacent to Commercial.
- Section F deleted with 2005 Master Plan update.
- Section N deleted and replaced with Sections N1 & N2.